



Addendum No. 2

Date Issued: February 21, 2019

RFP Name: Carpet and Cove Base for District Buildings RFP

RFP# 2019-PUR-002

Question and Answer (in blue below):

1. Can the School District make separate awards for each of the five Schools if fiscally advantageous to the District?
No.
2. Who will be responsible for the moving of the furniture, equipment, appliances and any gym seating within the five Schools?
School District will move items.
3. Will any Addendum be issued early in the day Friday 2/22 so that Bidders have a reasonable amount of time for consideration?
Will make a reasonable attempt to do so.
4. Is there a list of interest firms that can be available?
Not sure what he means on this, but the bid tabulation will be available once a contract is executed)
5. In the Korte Elementary School our representative measured a Library. There is no Library shown on the drawing for that School. Is the Library to be included in the Bid? Additionally, our representative did not measure the Kitchen as shown to be included for the Bid on the drawing. Is the Kitchen still to be included in the Bid?
The Library is included and is on the map. See below map with Library circled and it was included on the map in RFP. The kitchen was accidently circled it is Epoxy flooring.
6. Korte:
Gustavo mentioned something about the offices in the Library getting carpet even though the diagram did not indicate such. Please confirm, yes or no.
Yes.
7. Regarding Request for Proposal, Document Line 6.6.6 – Does this apply since unemployment is currently below 5% and what happens if unemployment goes over 5% by the time the work is done this summer? Also, is Kansas a non-restrictive state?
At this point this is not an issue, but we can address if necessary.



8. Line 6.6.9 - Has lead paint testing been performed at any of these schools and if not, how will it affect flooring contractors?

We do not believe to our knowledge that we have lead base paint in any district buildings. However, if you are concerned about any certain area, we will test at owner's expense.



Carpet

Korte Elementary School
 2437 S. Hardy Ave.
 Independence, MO 64052

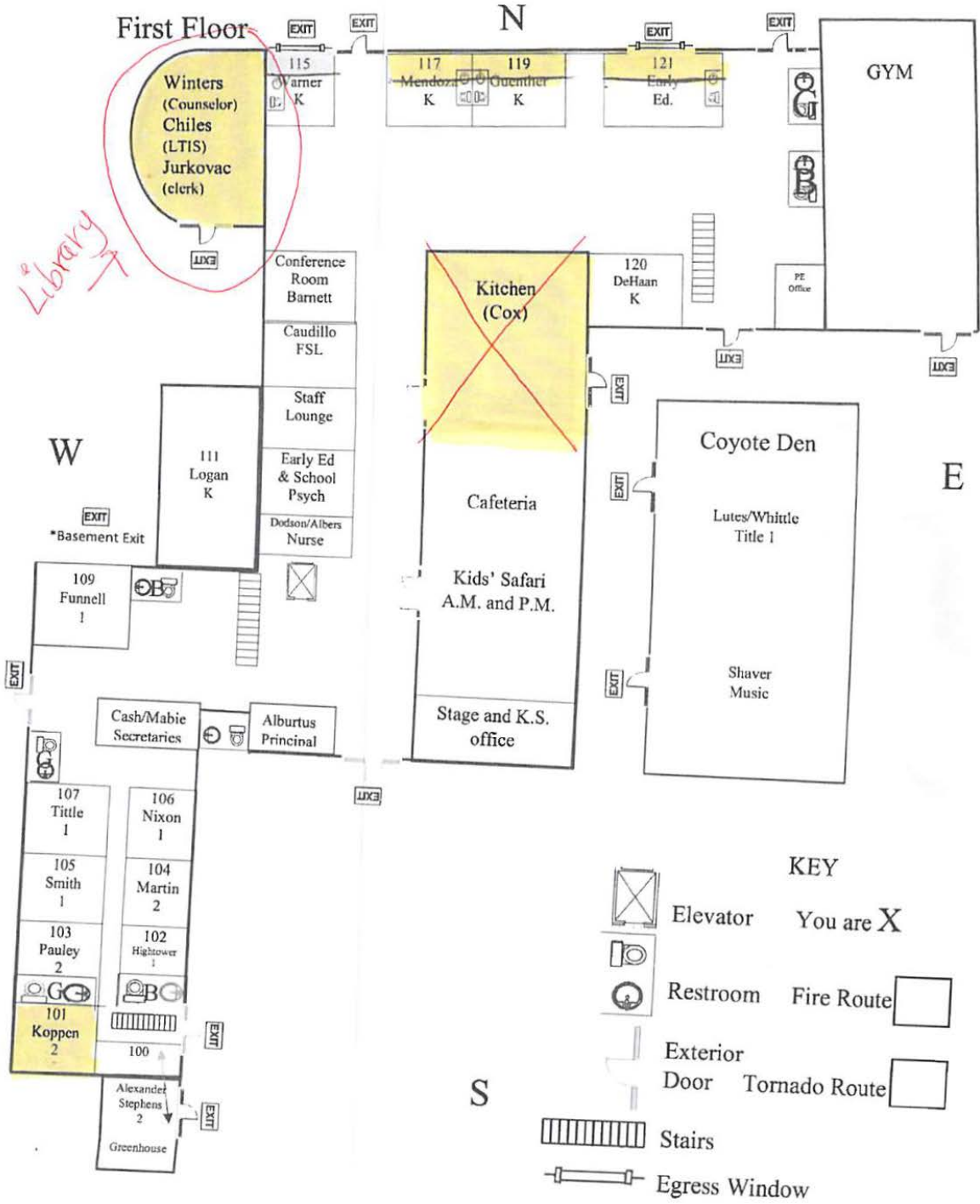
First Floor

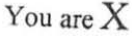

KEY

-  Elevator
-  Restroom
-  Exterior Door
-  Stairs
-  Egress Window
-  Fire Route
-  Tornado Route
-  You are X

